

Laser scanner carbon tripod for FARO Focus^{3D} & Trimble TX5

Quick Guide

1 General

Mobile and time-saving: you can set up and dismantle this light and rugged tripod as quick as lightning.

- 3/8-inch connection
- 4 extendable leg segments
- Transport length: 1.08 m
- Weight: approx. 2.43 kg
- Maximum load
- Maximum usable height: approx. 1.87 m
- Minimum usable height: approx. 0.40 m
- Material: carbon fiber 8X
- Bullseye circular spirit level and

2 Safety instructions



WARNING

If the load is excessive, the stop plates in the swivel clamps of the tripod leg segments will break.

Turn the swivel clamps carefully.



WARNING

If the ground is soft, icy or slippery, there is a risk that the tripod legs will slip. Use the rubber feet.



NOTE

If the position of the tripod is not perpendicular, vibrations occur during rotation of the laser scanner, impairing the quality of the scan. Use the spirit level to set up the tripod vertically.

3 Scope of delivery

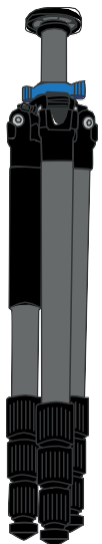

Carbon



Carrying bag



Carrying strap



Rubber

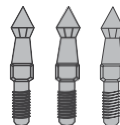

Spikes

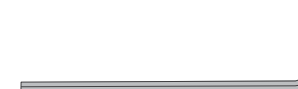

Hexagon key

4 Setting up the tripod with laser scanner

4.1 Pulling out the tripod legs

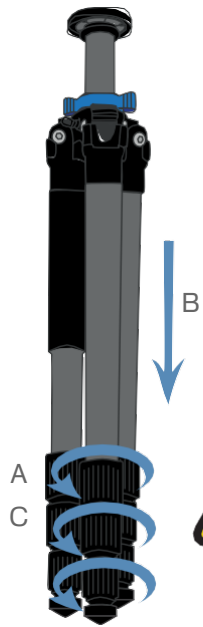

A

Undo the swivel clamps on each tripod leg.

B

Pull out the tripod legs to the desired height.

C

Retighten the swivel clamps on each tripod leg.

If the load is excessive, the stop plates in the swivel clamps of the tripod leg segments will break. Turn the clamps carefully.



4.2 Spreading the tripod legs

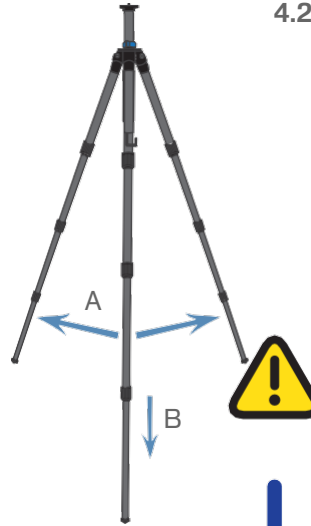

A

To optimize stability, pull the tripod legs apart as far as they will go.

B

Place the tripod on the ground.

If the ground is soft, icy or slippery, there is a risk that the tripod legs will slip. Use the rubber feet.

Observe the bullseye circular spirit level when setting up the tripod in the perpendicular.



4.3 Optional: spreading the tripod legs further apart

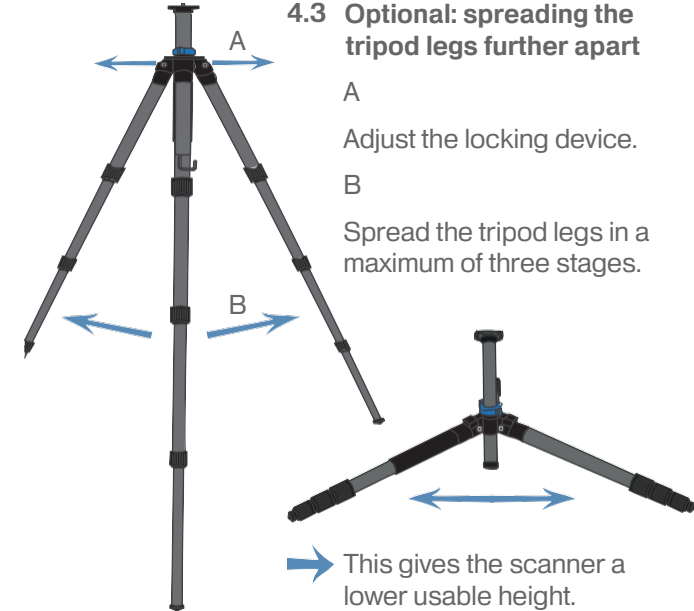

A

Adjust the locking device.

B

Spread the tripod legs in a maximum of three stages.

→ This gives the scanner a lower usable height.

Unscrew

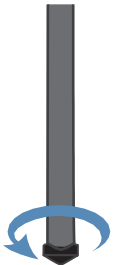

4.4 Optional: replacing tripod feet with spikes

Unscrew the rubber feet on all three tripod legs and screw in the spikes in their place.

Use the rubber feet if the ground is soft, icy or slippery.

On very soft or frozen ground, you should use the spikes.



Screw on

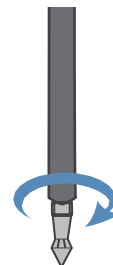

4.5 Extending the tripod head

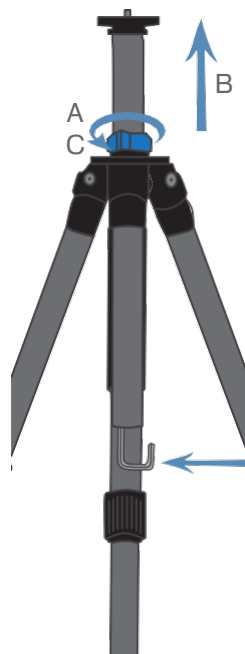

Undo the blue safety catch on the middle column.

B

Pull the tripod head out to the desired height.

C

Retighten the blue safety catch.

To ensure that the tripod has a stable stance, you can hang additional weight on the hook.



4.6 Mounting the laser scanner

Attach the laser scanner to the fitted adapter.

Optional:

We recommend the use of a quick-release clamp to make the work faster and more convenient.

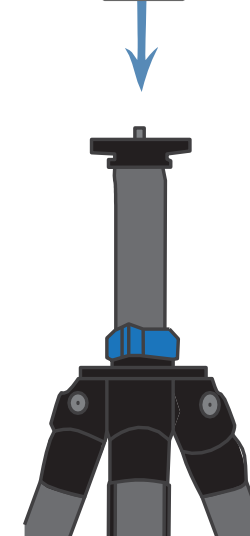

Contact

Laserscanning Europe GmbH
 Gustav-Ricker-Str. 62
 39120 Magdeburg
 Telephone: +49 (0)391 - 62 69
 96 0
 Telefax: +49 (0)391 - 250 9051
 Mail: info@laserscanning-europe.com